

JOB: UNIT TAG: ENGINEER: CONTRACTOR:	REPRESENTATIVE: ORDER NO. SUBMITTED BY: APPROVED BY:	DATE: DATE: DATE:
---	---	--

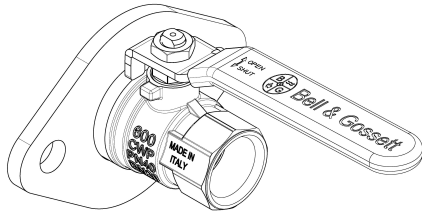

Isolation Flanges

NPT and Sweat Connection

DESCRIPTION

The isolation flange is a combination of an isolation ball valve and a companion flange for circulators. The isolation flange allows easy service or replacement of the circulator without the need to drain the system. The isolation flange fits the Bell & Gossett NRF/NBF/SSF wet rotors, Series PL, Series 100, PR and LR circulators.

Available Sizes: 3/4", 1", 1-1/4" & 1-1/2" (refer to dimension and weight table for details)

OPERATIONAL DATA

Maximum working pressure: 150 psig (10 bar)

Maximum operating temperature: 200°F (93°C)

CONSTRUCTION

Valve Body: Lead-Free[†] Brass

Flange: Chrome Plated Steel

Ball: Chrome Plated Lead-Free[†] Brass

Packing: Teflon*

Seat Ring: Teflon

Stem: Lead-Free[†] Brass

*Teflon is a registered trademark of E.I. DuPont de Nemours and Company.

[†]Contains less than 0.25% Lead content by weight on wetted surface.

Part No.	Size Inches	Use With Following B&G Circulators	Tagging	Quantity
101221LF	3/4" NPTF IF	NRF/NBF/SSF, Series PL-30, PL-36, PL-55, Series 100, PR, and LR		
101222LF	1" NPTF IF			
101223LF	1-1/4" NPTF IF			
101241LF	1-1/2" NPTF IF			
101226LF	3/4" SWT IF	NRF/NBF/SSF, Series PL-30, PL-36, PL-55, Series 100, PR, and LR		
101227LF	1" SWT IF			
101228LF	1-1/4" SWT IF			
101243LF	1-1/2" SWT IF			

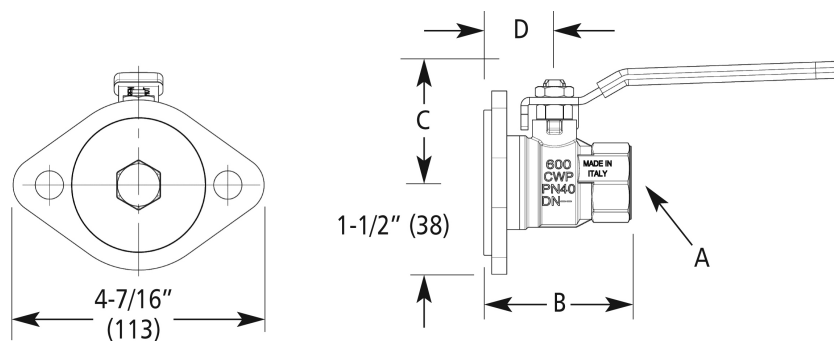

Part No.	Dimensions-Inches(mm)				Approx. Shpg. Wt. Lbs. (Kg)
	A	B	C	D	
101221LF	3/4" NPT	2-27/64" (61.5)	2" (50.5)	4-47/64" (120)	3.2 (1.5)
101222LF	1" NPT	2-57/64" (73.3)	2-5/32" (54.7)	4-47/64" (120)	4.1 (1.9)
101223LF	1-1/4" NPT	3-19/64" (84)	3" (75.9)	6-7/32" (158)	5.8 (2.6)
101241LF	1-1/2" NPT	3-23/64" (85.5)	3" (75.9)	6-7/32" (158)	6.1 (2.8)
101226LF	3/4" SWT	2-41/64" (67)	2" (50.5)	4-23/32" (120)	3.2 (1.5)
101227LF	1" SWT	3" (75.3)	2-5/32" (54.7)	4-23/32" (120)	3.9 (1.8)
101228LF	1-1/4" SWT	3-25/64" (86)	3" (75.9)	6-7/32" (158)	5.4 (2.5)
101243LF	1-1/2" SWT	3-35/64" (90)	3" (75.9)	6-7/32" (158)	6 (2.7)

Dimensions and weights are approximate and subject to change. Contact factory for certified dimensions .
The part numbers and shipping weights are for two Isolation flanges, capscrews and nuts.

TYPICAL SPECIFICATIONS

Furnish and install as shown on plans _____" NPT/Sweat x Flange isolation flanges on each side of the circulator(s). When closed, the isolation flanges isolate the circulator from the rest of the system so the system does not need to be drained when removing the circulator. The isolation valve shall be constructed with a brass body, chrome plated brass ball, chrome plated steel flange and handle, and teflon packing and seat ring. the mating flange shall be free floating allowing it to rotate eliminating the need to align the bolt holes of the flanges when installing to the system piping. The isolation flange shall be Xylem Bell & Gossett or equal.

Xylem Inc.
8200 N. Austin Avenue
Morton Grove, IL 60053
Phone: (847)966-3700
Fax: (847)965-8379
www.bellgossett.com

Bell & Gossett is a trademark of Xylem Inc. or one of its subsidiaries.
© 2015 Xylem Inc.

xylem
Let's Solve Water